

NOTES:

1. To be tightened according to Aprilia Tuareg 660 Workshop Manual.
2. Do not use Loctite or other thread locking compounds on screws and nuts. Use copper grease.
3. Assembly sequence:
 - 3.1 Attach the Quick Release Bracket to the windscreen, using the OEM nut, screw and rubber bushing. Tighten finger tight.
 - 3.2 Glue the Washer to the Knob. Make sure the washer is centered on the Knob.
 - 3.3 Insert the M5 nut into the Tower Block.
 - 3.4 Insert the Tower Block into the triangular opening in the tower.
 - 3.5 Lock the Tower Block using the QL Clamp.
 - 3.6 Insert the M5 screw into the Knob.
 - 3.7 Screw partially the Knob into the Tower Block, leaving about 10mm between Knob and Tower Block.
 - 3.8 Repeat on the right hand side, using the Quick Release Bracket R instead of the Quick Release Bracket L
 - 3.9 Position the windscreen so that the QR Brackets slide in the space between Tower Block and Knob. Tighten slightly the Knob.
 - 3.10 Tighten up the windscreen screws, see NOTE 1.
4. The QL Clamp is only meant to keep safely the Tower Block in place during assembly/disassembly. It is not necessary once all the parts are mounted, but it can be let in place.

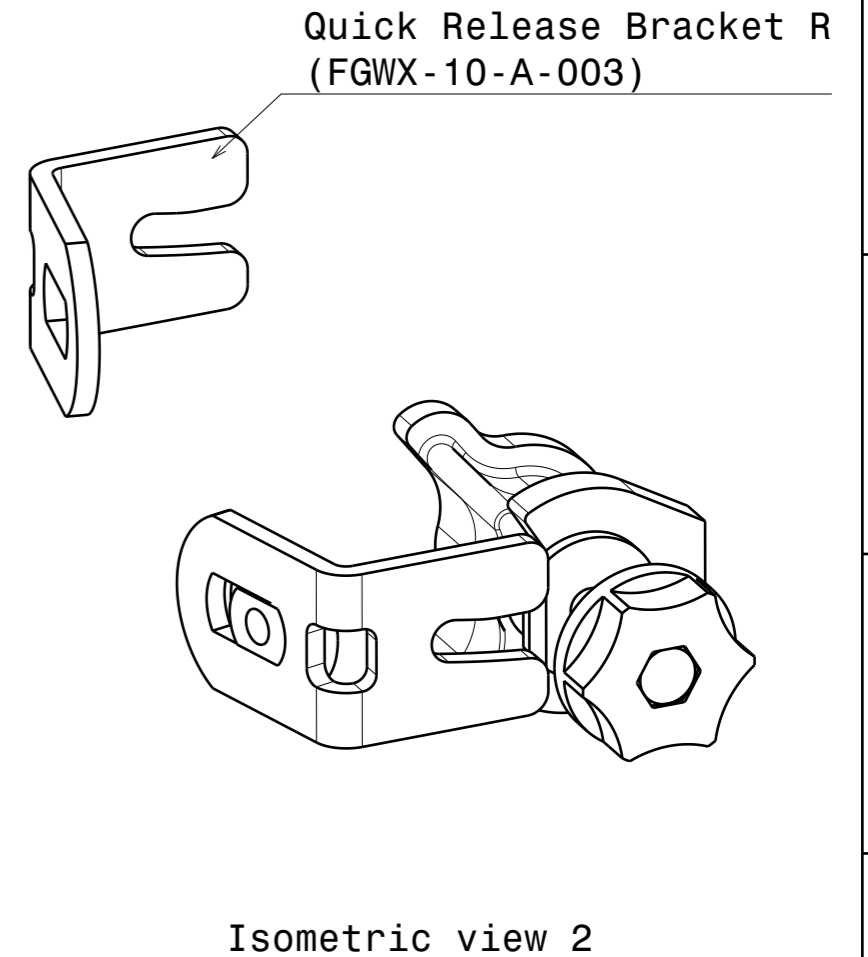
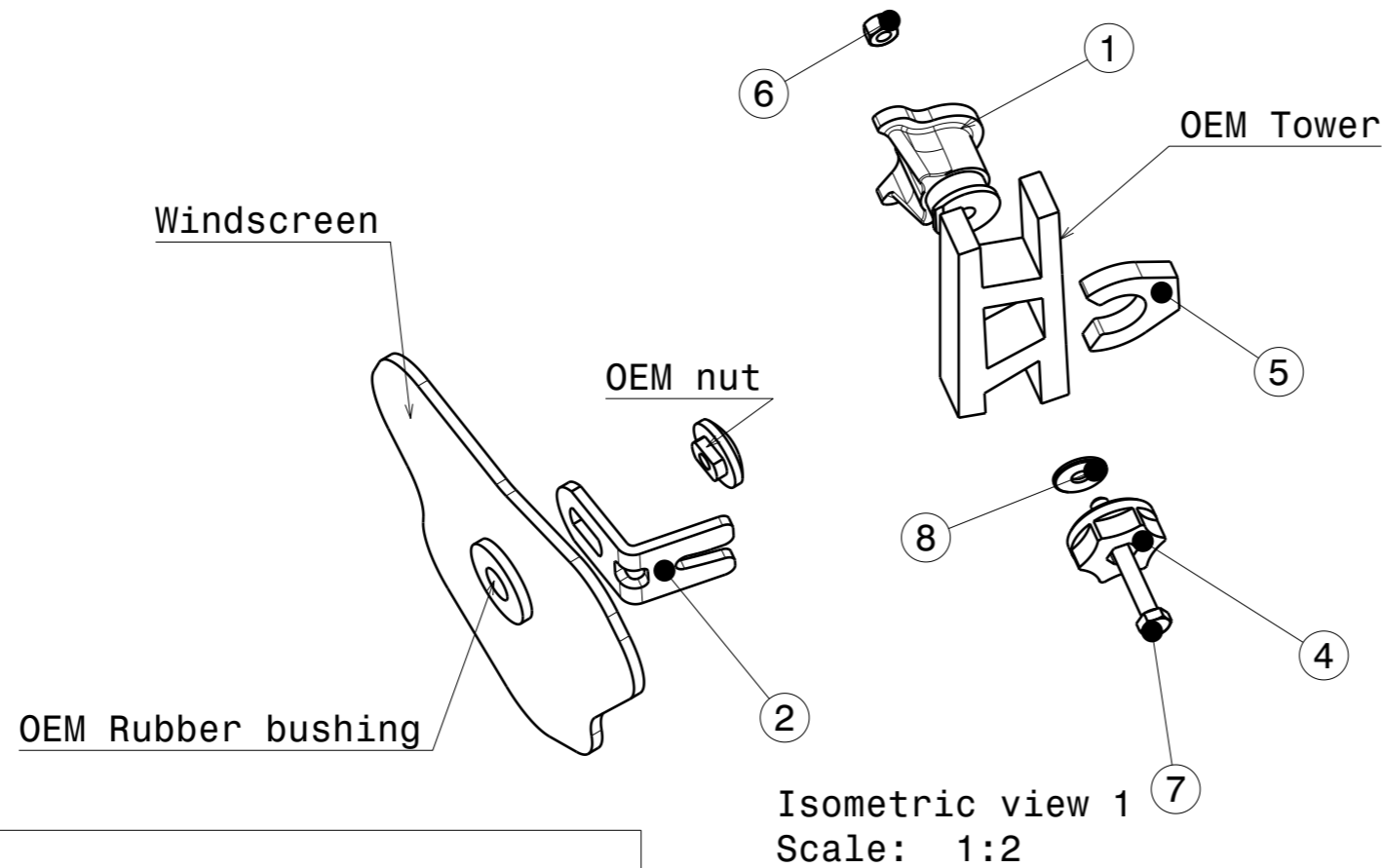

PART LIST			
Description	Part Number	F/N	Qty
Tower Block	FGWX-10-A-001	1	1
Quick Release Bracket L	FGWX-10-A-002	2	1
Knob	FGWX-010-A-005	4	1
QL Clamp	FGWX-010-A-006	5	1
Nut M5		6	1
Screw M5x40		7	1
Washer M5		8	1

SCALE 1:1		BREAK ALL EDGES (R ALT. 45°) 0.1-0.5 THREAD TOL. 6g/6H ISO R965/1 ALL DIM. INCLUDE SURFACE TREATMENT		GWORX	
ROUGH Ra μm	FILLET RADII	DIM TOL	ANG TOL	PROJECTION	
DATE	DESCRIPTION Windscreen Quick Lock				
DESIGN GWORX	-				
DRAWN GWORX	-				
MAT.	SURF. TREATMENT		-		
SIZE	DOC.NO. FGWX-10-A	REV.	SHEET 1 OF 1		