

NOTES:

1. To be tightened according to Aprilia Tuareg 660 Workshop Manual.
2. Do not use Loctite or other thread locking compounds. Use copper grease.
3. The spacer is not cylindrical. The angled face shall be at the interface with the Rear Rack.
4. Assembly sequence:
 - 4.1 Put all parts in position.
 - 4.2 Slightly tighten the M6 screws.
 - 4.3 Tighten the M8 screw finger tight.
 - 4.5 Adjust the angle of the Rear Rack wrt the bike tail.
 - 4.6 Tighten the M8 screw. See NOTE 1.
 - 4.7 Tighten the two M6 screws. See NOTE 1.

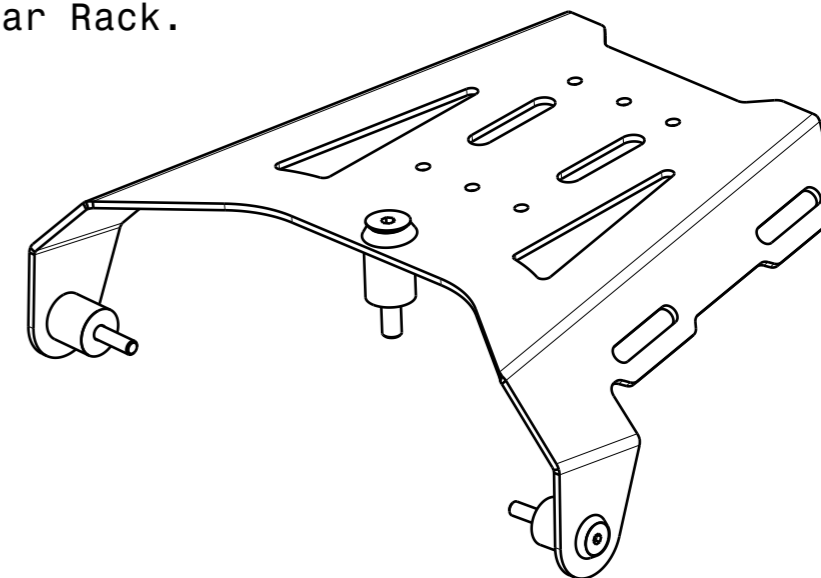

Isometric view
Scale: 1:3

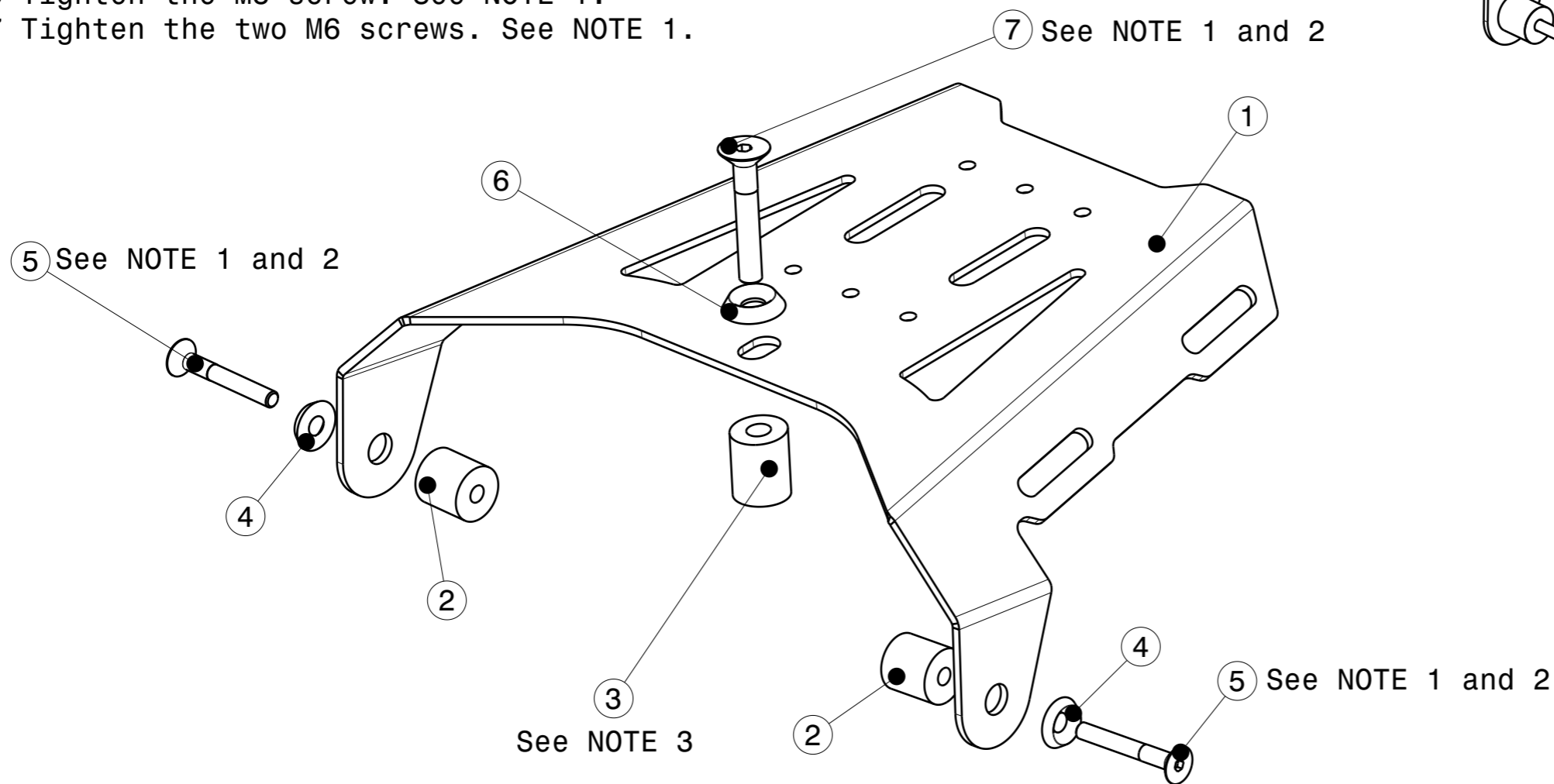

Isometric view
Scale: 1:2

PART LIST			
Description	Part Number	F/N	Qty
Rear Rack	FGWX-04-A-001	1	1
Spacer 6x20x20		2	2
Center Spacer	FGWX-04-A-003	3	1
Csk Screw M6x45		4	2
Csk Washer M6		5	2
Csk Screw M8x50		6	1
Csk Washer M8		7	1

SCALE 1:1	BREAK ALL EDGES (R ALT. 45°) 0.1-0.5 THREAD TOL. 6g/6H ISO R965/1 ALL DIM. INCLUDE SURFACE TREATMENT		GWORX	
ROUGH Ra μm -	FILLET RADII -	DIM TOL -	ANG TOL -	PROJECTION
DATE -	DESCRIPTION Rear Rack			
DESIGN GWORX	-			
DRAWN GWORX	-			
MAT. -	SURF. TREATMENT -		-	
SIZE -	DOC.NO. FGWX-04-A	REV. -	SHEET 1 OF 1	