

- NOTES:
- 1. To be tightened according to Aprilia Tuareg 660 Workshop Manual.
  - 2. Do not use Loctite or other thread locking compounds. Use copper grease.
  - 3. Assembly sequence:
    - 3.1 Put the handles in place.
    - 3.2 Insert the M3 screws and nut and tighten them to 0.6Nm.  
Do not overtighten them. See NOTE 1.
    - 3.3 Position the Rear Rack, then insert spacers, washers and screws.
    - 3.4 Tighten the two M8 screw. See NOTE 1.
    - 3.5 Tighten the two M6 screws. See NOTE 1.

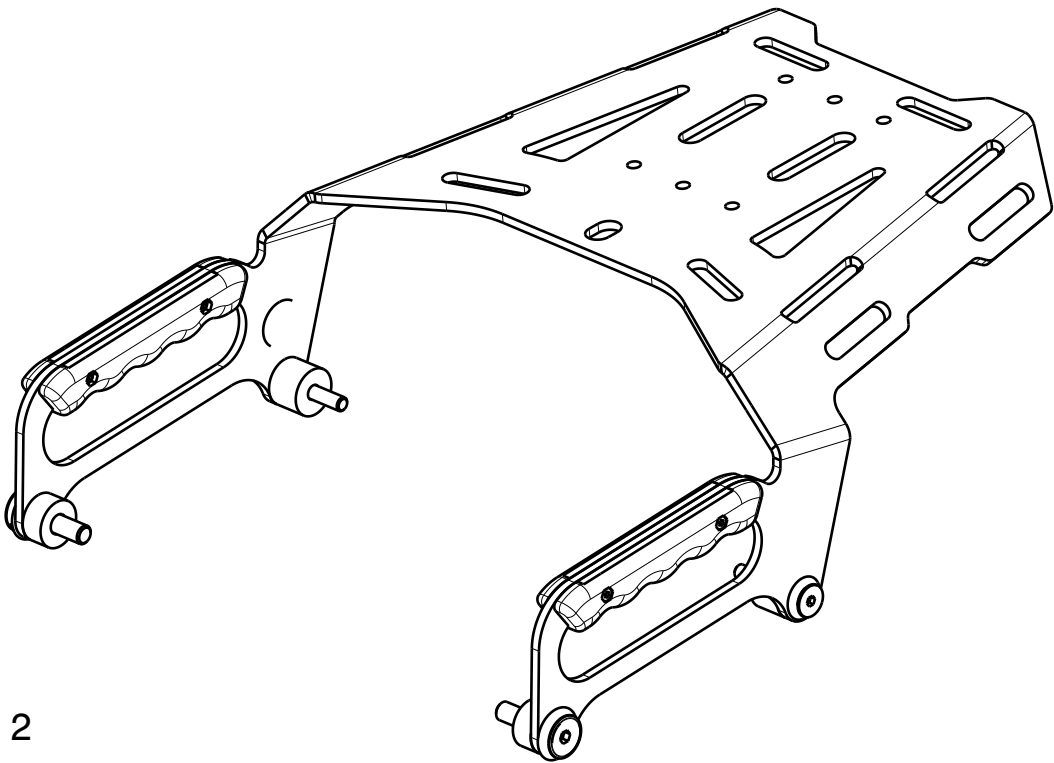

Isometric view  
Scale: 1:3

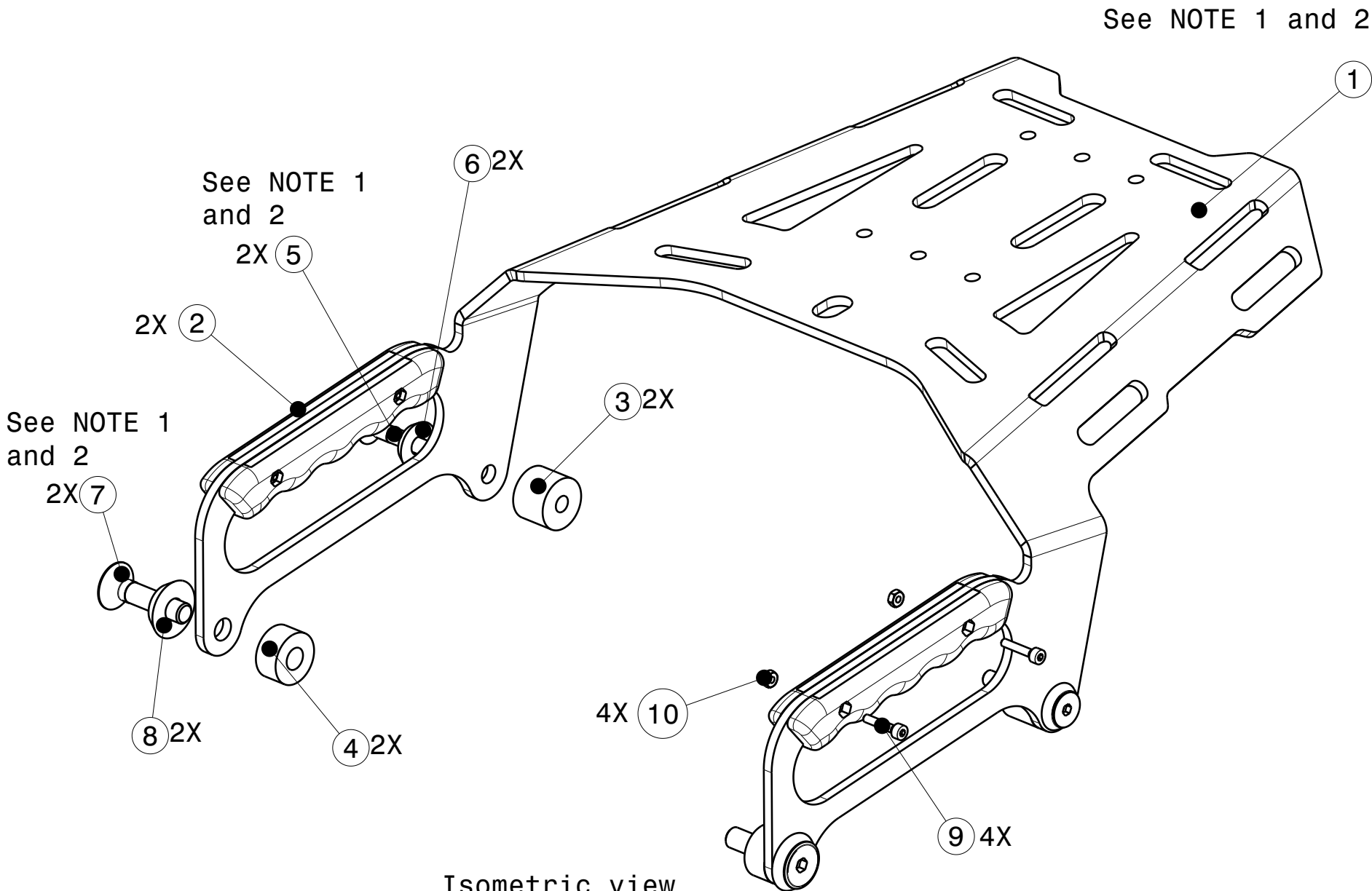

Isometric view  
Scale: 1:2

PART LIST			
Description	Part Number	F/N	Qty
Rear Rack HD	FGWX-04-B-001	1	1
Handle single	FGWX-04-B-006	2	2
Spacer 6x20x15		3	2
Spacer 8x20x10		4	2
Csk Screw M6x40		5	2
Csk Washer M6		6	2
Csk Screw M8x35		7	2
Csk Washer M8		8	2
Screw M3x16		9	4
Nut M3		10	4

SCALE 1:1		BREAK ALL EDGES (R ALT. 45°) 0.1-0.5 THREAD TOL. - 6g/6H ISO R965/1 ALL DIM. INCLUDE SURFACE TREATMENT		GWORX	
ROUGH Ra μm	-	FILLET RADII	-	DIM TOL	-
DATE	-	ANG TOL	-	PROJECTION	
DESIGN	GWORX		DESCRIPTION Rear Rack HD		
DRAWN	GWORX		-		
MAT.	-	SURF. TREATMENT	-	REV.	-
SIZE	-	DOC.NO.	FGWX-04-B		SHEET 1 OF 1