

NOTES:

1. To be tightened according to Aprilia Tuareg 660 Workshop Manual.
2. Do not use Loctite or other thread locking compounds. Use copper grease.

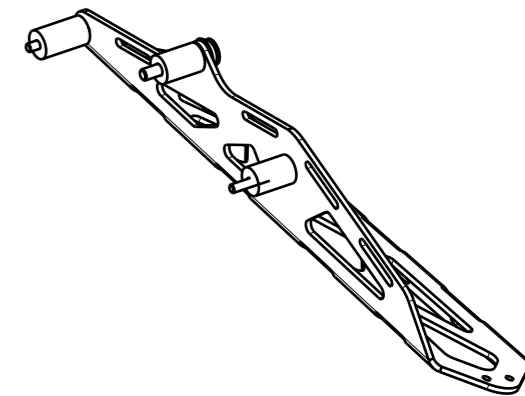
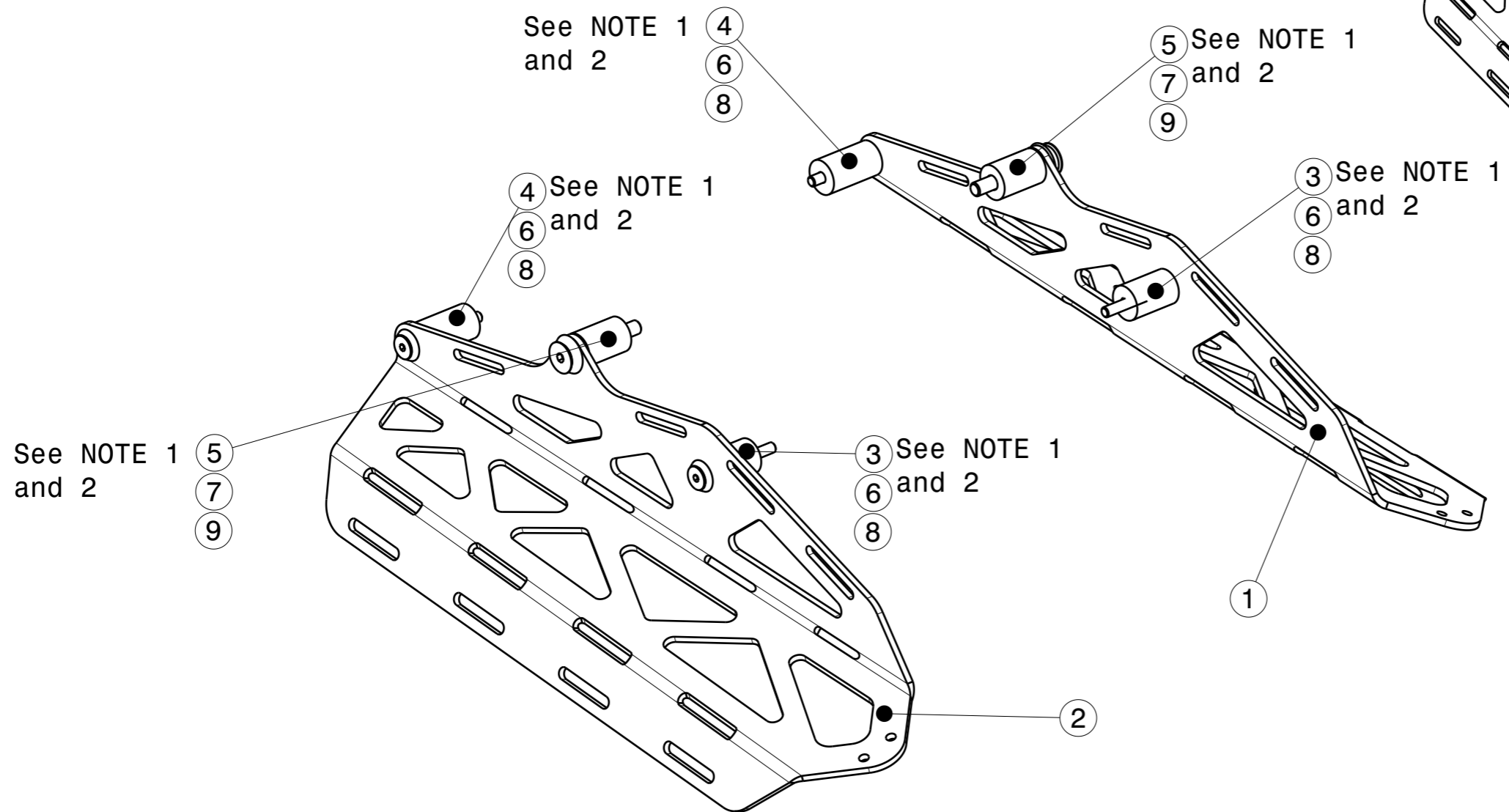

Isometric view
Scale: 1:5

Isometric view
Scale: 1:3

PART LIST

Description	Part Number	F/N	Qty
Siderack HD L	FGWX-05-B-001	1	1
Siderack HD R	FGWX-05-B-002	2	1
Spacer 6x20x30		3	2
Spacer 6x20x35		4	2
Spacer 8x20x30		5	2
Csk Washer M6		6	4
Csk Washer M8		7	2
Csk Screw M6x55		8	4
Csk Screw M8x55		9	2

SCALE 1:1		BREAK ALL EDGES (R ALT. 45°) 0.1-0.5		GWORX	
ROUGH Ra μm -		FILLET RADII -			
DATE -		DIM TOL -		ANG TOL -	
DESIGN GWORX		DESCRIPTION Siderack HD			
DRAWN GWORX		PROJECTION			
MAT. -		SURF. TREATMENT -		REV. -	
SIZE -	DOC. NO. FGWX-05-B	REV. -		SHEET 1 OF 1	